

Note:

Materials:

.Insulator: Black high temperature plastics U194 V-0

.Plunger: Brass 0.25um Au over Ni

.Barrel: Brass 0.25um Au over Ni

.Spring: SUS surface treatment

To ensure the best usage, please operate it based on the working height.
Based on the engineering drawings, shall not exceed the maximum allowed compression.

Mechanical:

.Contact force: 60g±20g at 4.7mm working height

.Life test: 20,000 cycles

Electrical:

.Rated current & voltage: DC 12V; 1A

.Contact resistance: 50 milliohm Max.

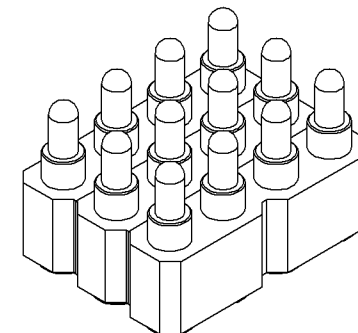

Approve Sign

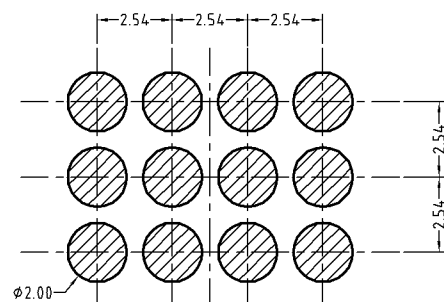
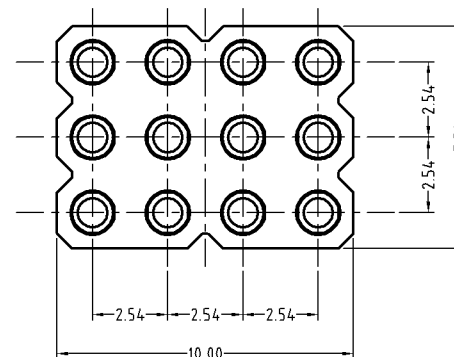
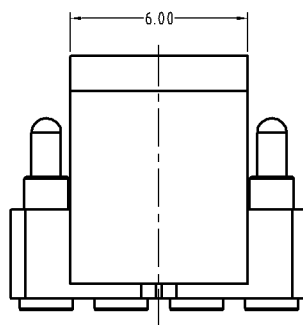
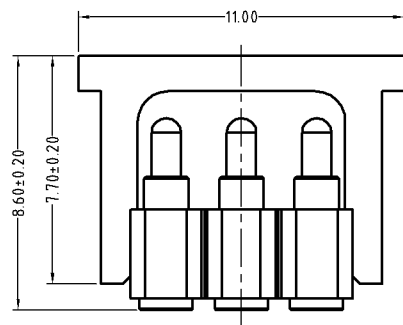

Recommended pcb layout
layout tolerance: ±0.05mm

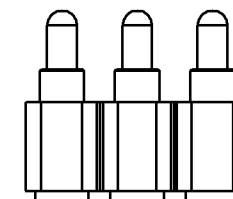
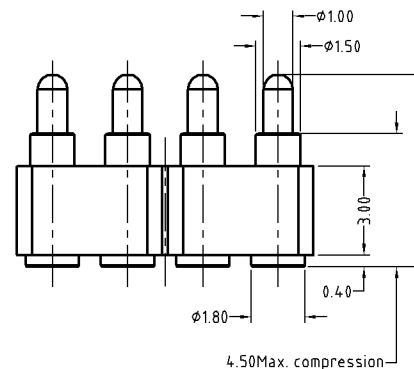
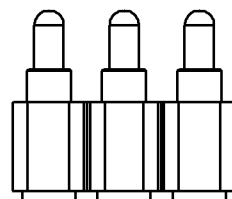

SCALE	10:1	UNIT:mm	THIS DOCUMENT IS THE SOLE PROPERTY OF CFE CORPORATION CO.,LTD., AND SHOULD NOT BE USED IN WHOLE OR IN PART WITHOUT PRIOR WRITTEN PERMISSION.	CFE 东莞市川富电子有限公司 CFE CORPORATION CO.,LTD.	
ANGEL	±1°	A4			
0~6	±0.10		SHEET: 1 of 1	PART NO.	BF39311-12254H0A
6~30	±0.15	DRAW		FILE NAME	BF393XX
30~150	±0.20	CHECK		TITLE.	Pogo pin connector
ECN(DCN) NO.	REV	DATE	DESCRIPTION	APPRO	

_____	D0	2015.04.07	NEW
ECN(DCN) NO.	REV	DATE	DESCRIPTION