

1

2

3

4

Note:  
 Materials:  
 .Plunger: Brass 0.025um Au over Ni.  
 .Spring: SUS surface treatment  
 .Barrel: Brass 0.025um Au over Ni.

To ensure the best usage, please operate it based on the working height.  
 Based on the engineering drawings, shall not exceed the maximum allowed compression.

Mechanical:  
 .Contact force: 10g±20g at 1.0mm working stroke  
 .Life test: 100,000 cycles

Electrical:  
 .Rated voltage: DC12V; 1A Max.  
 .Contact resistance: 50 milliohm Max.

Cannot be used as the charging,



Approve Sign

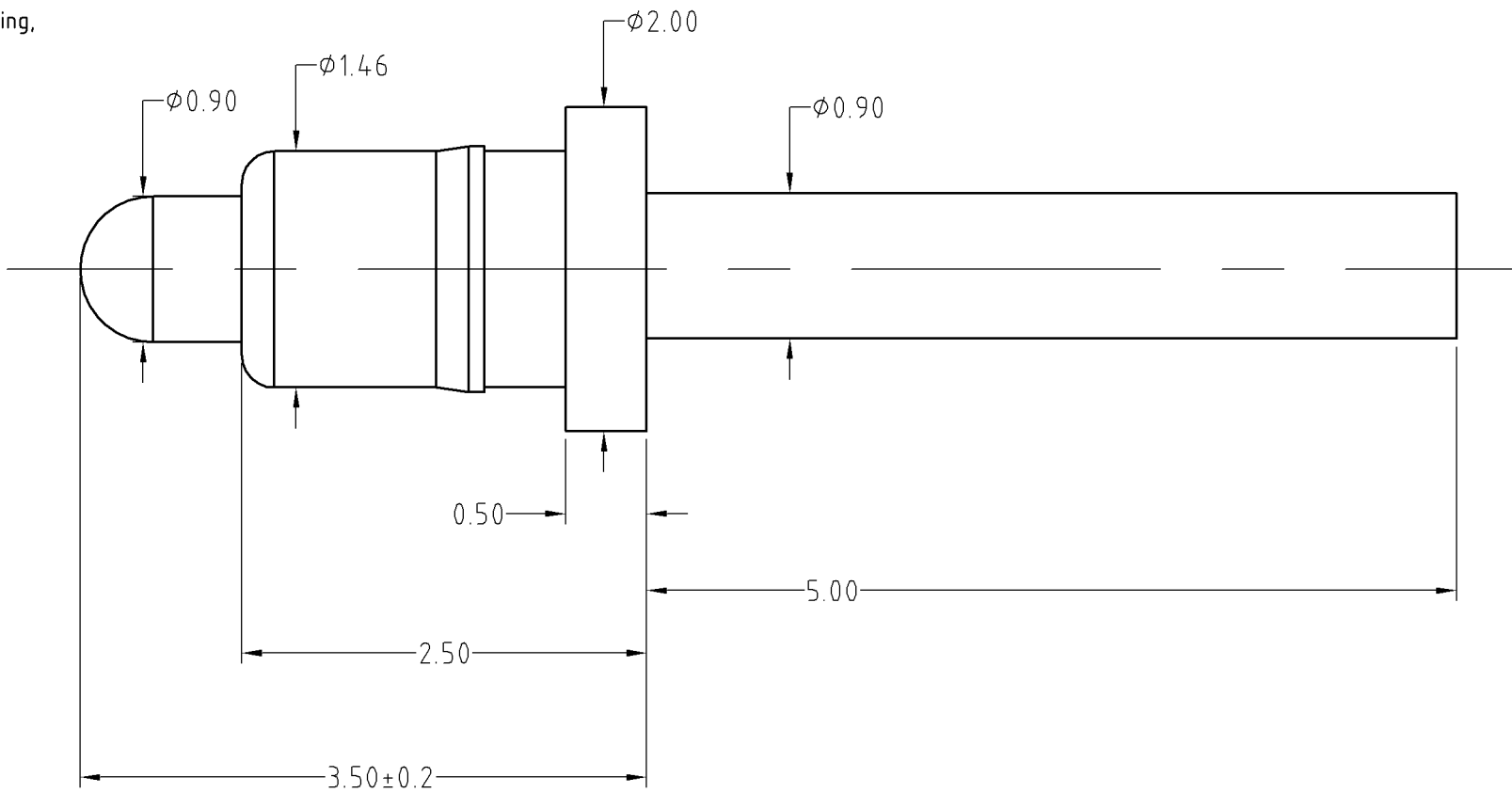

SCALE	10:1	UNIT:mm	THIS DOCUMENT IS THE SOLE PROPERTY OF CFE CORPORATION CO.,LTD., AND SHOULD NOT BE USED IN WHOLE OR IN PART WITHOUT PRIOR WRITTEN PERMISSION.	
ANGEL	±1°	A4	SHEET: 1 of 1	
0~6	±0.05		PART NO.	BP03311
6~30	±0.10	DRAW	FILE NAME	BP03311
30~150	±0.15	CHECK	TITLE	Pogo pin connector
GENERAL TOLERANCE UNLESS OTHERWISE NOTED		APPRO		



ECN(DCN) NO.	D0	2013.05.30	NEW
REV	DATE	DESCRIPTION	