

1

2

3

4

Note:

Materials:

.Plunger: Brass 60u" Au over Ni

.Barrel: Brass 60u" Au over Ni

.Spring: SUS Au

Mechanical:

.Contact force: 190g±40g at 1.3mm working stroke

.Full stroke: 1.5mm

.Life test: 500,000 cycles (working stroke)

Electrical:

.Rated current &amp; voltage: DC 12V; 2A Max.

.Contact resistance: 30 milliohm Max.

To ensure the best usage, please operate it based on the working height.

Based on the engineering drawings, shall not exceed the maximum allowed compression.



Approve Sign

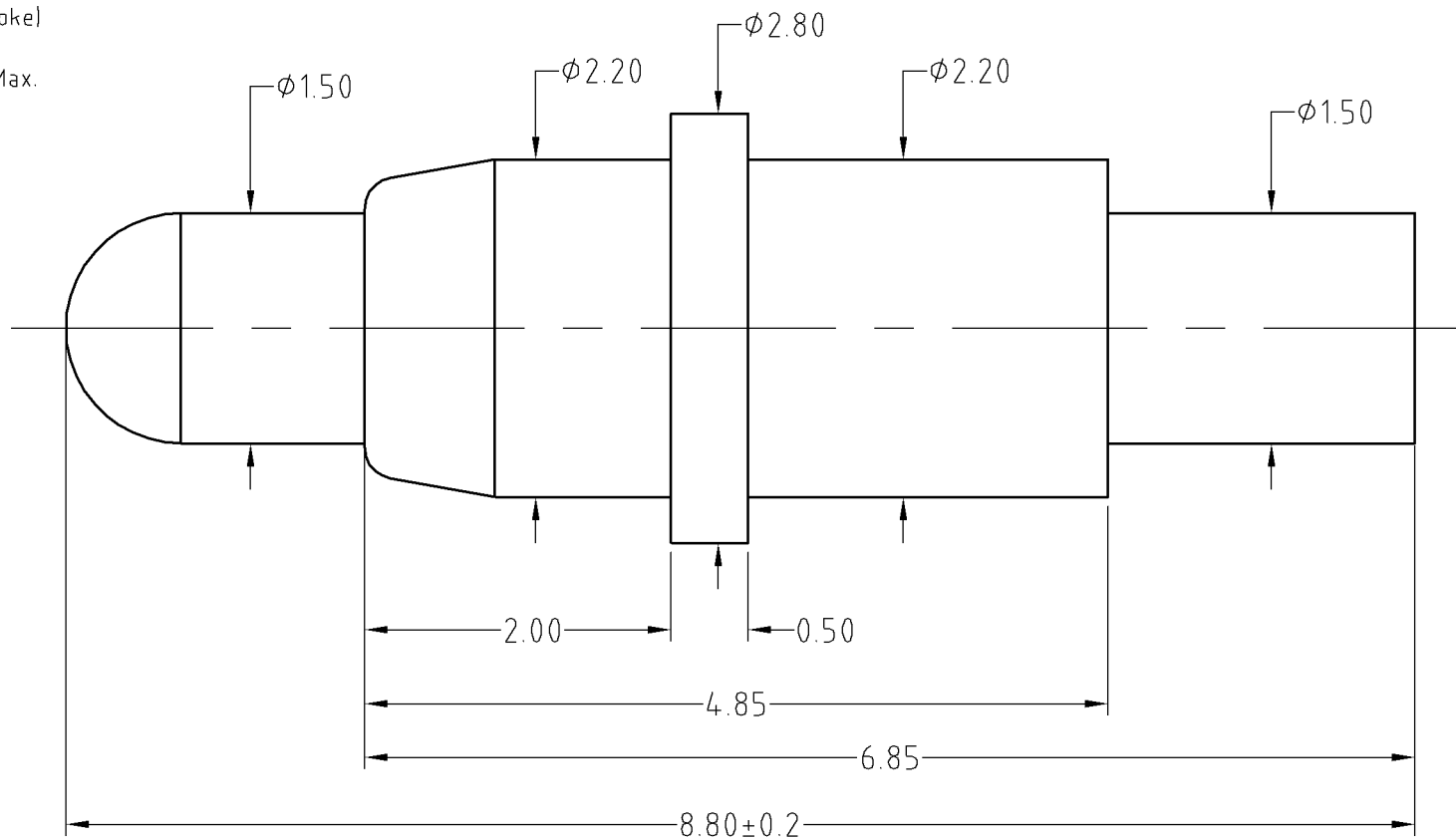

SCALE	10:1	UNIT:mm	THIS DOCUMENT IS THE SOLE PROPERTY OF CFE CORPORATION CO.,LTD., AND SHOULD NOT BE USED IN WHOLE OR IN PART WITHOUT PRIOR WRITTEN PERMISSION.	<b>CFE</b> 东莞市川富电子有限公司 CFE CORPORATION CO.,LTD.
ANGEL	$\pm 1^\circ$	A4		
0-6	$\pm 0.05$		SHEET: 1 of 1	
6-30	$\pm 0.10$	DRAW		PART NO. BP034.12
30-150	$\pm 0.15$	CHECK		FILE NAME BP034.11
GENERAL TOLERANCE UNLESS OTHERWISE NOTED		APPRO		TITLE. Pogo pin connector

ECN(DCN) NO.	D0	2013.05.30	NEW
REV	DATE	DESCRIPTION	