

HSF 禁止使用1级环境管理物质

To ensure the best usage, please operate it based on the working height.
Based on the engineering drawings, shall not exceed the maximum allowed compression.

Note:

Materials:

- .Plunger: Brass 1u" Au over Ni
- .Barrel: Brass 1u" Au over Ni
- .Spring: SUS Au

Mechanical:

- .Contact force: 90g±20g at 1.5mm working stroke
- .Life test: 20,000 cycles

Electrical:

- .Rated current & voltage: DC 12V; 1A
- .Contact resistance: 50 milliohm Max.

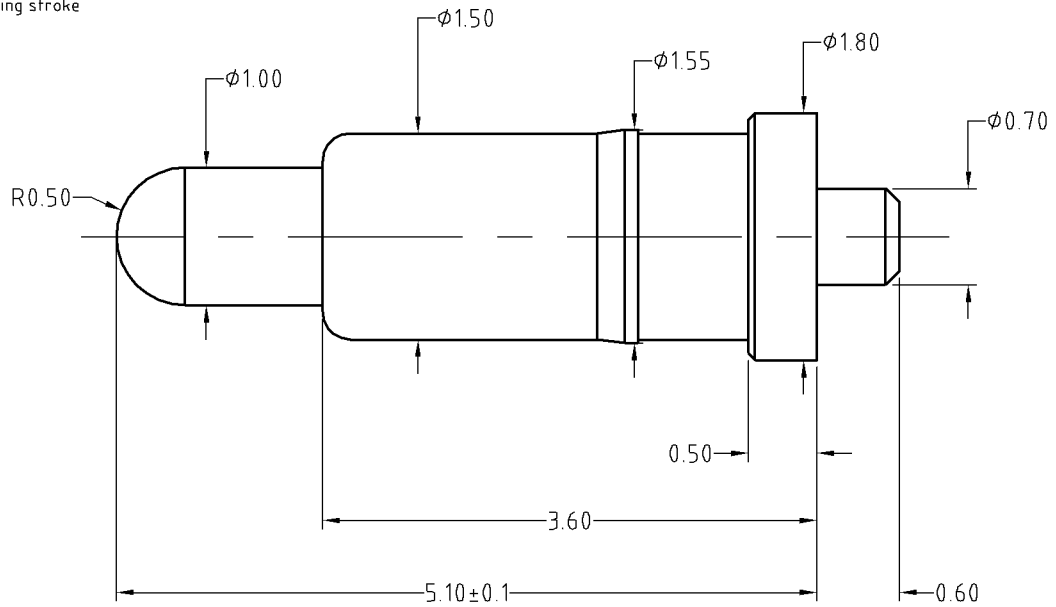

SCALE	10:1	UNIT-mm	THIS DOCUMENT IS THE SOLE PROPERTY OF CFE CORPORATION CO.,LTD. AND SHOULD NOT BE USED IN WHOLE OR IN PART WITHOUT PRIOR WRITTEN PERMISSION.
ANGEL	$\pm 1^\circ$	A4	
0-6	± 0.05		
6-30	± 0.10		
30-120	± 0.15	CHECK	SHEET: 1 of 1
GENERAL TOLERANCE UNLESS OTHERWISE NOTED			APPRO

CFE 东莞市川雷电子有限公司
CFE CORPORATION CO.,LTD.

ECN/CN1 NO.	REV	DATE	DESCRIPTION	CHANGE	APPRO	PART NO.	BP11511
						FILE NAME	BP11511
						TITLE	Paga pin connector