

1 2 3 4

Note:

Materials:

.Plunger: Brass 1u" Au over Ni

.Barrel: Brass 1u" Au over Ni

.Spring: SUS Au

Mechanical:

.Contact force: 70g±20g at 1.5mm working stroke

.Life test: 20,000 cycles

Electrical:

.Rated current & voltage: DC 12V; 1A

.Contact resistance: 50 milliohm Max.

To ensure the best usage, please operate it based on the working height.
Based on the engineering drawings, shall not exceed the maximum allowed compression.

| Part | NO. | Qty |
|---------|------------|-----|
| Plunger | B115-P3001 | 1 |
| Spring | B115-S03 | 1 |
| Barrel | B115-B1001 | 1 |

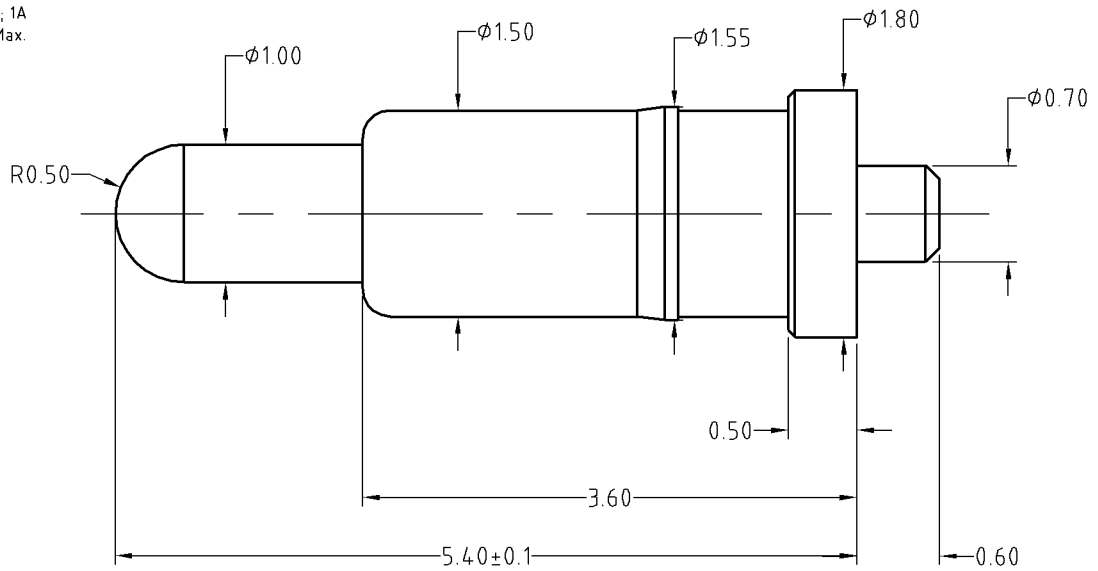

| SCALE | 10:1 | UNIT-mm | mm |
|--|-------|---------|----|
| ANGLE | ±1° | A4 | |
| 0-6 | ±0.05 | | |
| 6-30 | ±0.10 | DRAW | |
| 30-120 | ±0.15 | CHECK | |
| GENERAL TOLERANCE UNLESS OTHERWISE NOTED | | APPRO | |

THIS DOCUMENT IS THE SOLE PROPERTY OF CFE CORPORATION CO.,LTD. AND SHOULD NOT BE USED IN WHOLE OR IN PART WITHOUT PRIOR WRITTEN PERMISSION.

CFE 东莞市川雷电子有限公司
CFE CORPORATION CO.,LTD.

PART NO. BP11513

FILE NAME BP11511

TITLE. Paga pin connector

| ECN/CN1 NO. | REV | DATE | DESCRIPTION |
|-------------|-----|------------|-------------|
| | A0 | 2014.02.24 | NEW |