

1

2

3

4

Note:

Materials:

.Plunger: Brass 20u" Au over Ni

.Barrel: Brass 20u" Au over Ni

.Spring: SUS surface treatment

Mechanical:

.Contact force: 80g±20% at 1.0mm working stroke

.Life test: 100,000 cycles

Electrical:

.Rated current &amp; voltage: DC 12V; 3A Max.

.Contact resistance: 50 milliohm Max.

To ensure the best usage, please operate it based on the working height.

Based on the engineering drawings, shall not exceed the maximum allowed compression.



Approve Sign

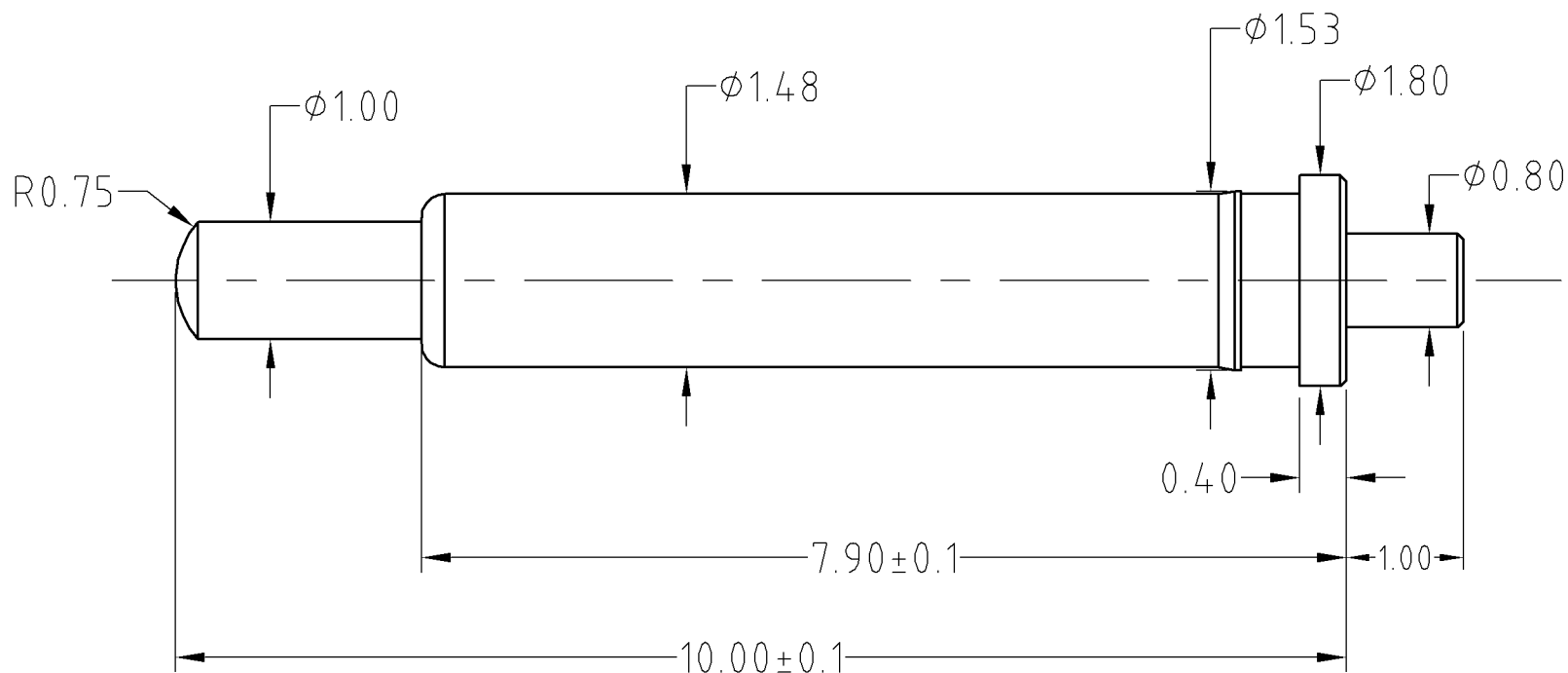

BOM

Part	NO.	Qty
Plunger	B168-P1020	1
Barrel	B168-B1020	1
Spring	B168-S01	1

SCALE	10:1	UNIT:mm	THIS DOCUMENT IS THE SOLE PROPERTY OF CFE CORPORATION CO.,LTD., AND SHOULD NOT BE USED IN WHOLE OR IN PART WITHOUT PRIOR WRITTEN PERMISSION.	SHEET: 1 of 1	PART NO.	BP16811
ANGEL	$\pm 1^\circ$	A4				
0-6	$\pm 0.05$				FILE NAME	BP168XX
6-30	$\pm 0.10$	DRAW			TITLE.	Pogo pin connector
30-150	$\pm 0.15$	CHECK				
GENERAL TOLERANCE UNLESS OTHERWISE NOTED		APPRO				

**CFE** 东莞市川富电子有限公司  
CFE CORPORATION CO.,LTD.

ECN(DCN) NO.	REV	DATE	DESCRIPTION
	D0	2013.05.30	NEW