

1

2

3

4

Note:

Materials:

.Plunger: Brass 100u" Ni

.Barrel: Brass 100u" Ni

.Spring:

Mechanical:

.Contact force: 220g±20% at 1.5mm working stroke

.Full stroke: 2.0mm

.Life test: 20,000 cycles

salt fog: 8 hours

To ensure the best usage, please operate it based on the working height.
Based on the engineering drawings, shall not exceed the maximum allowed compression.



Approve Sign

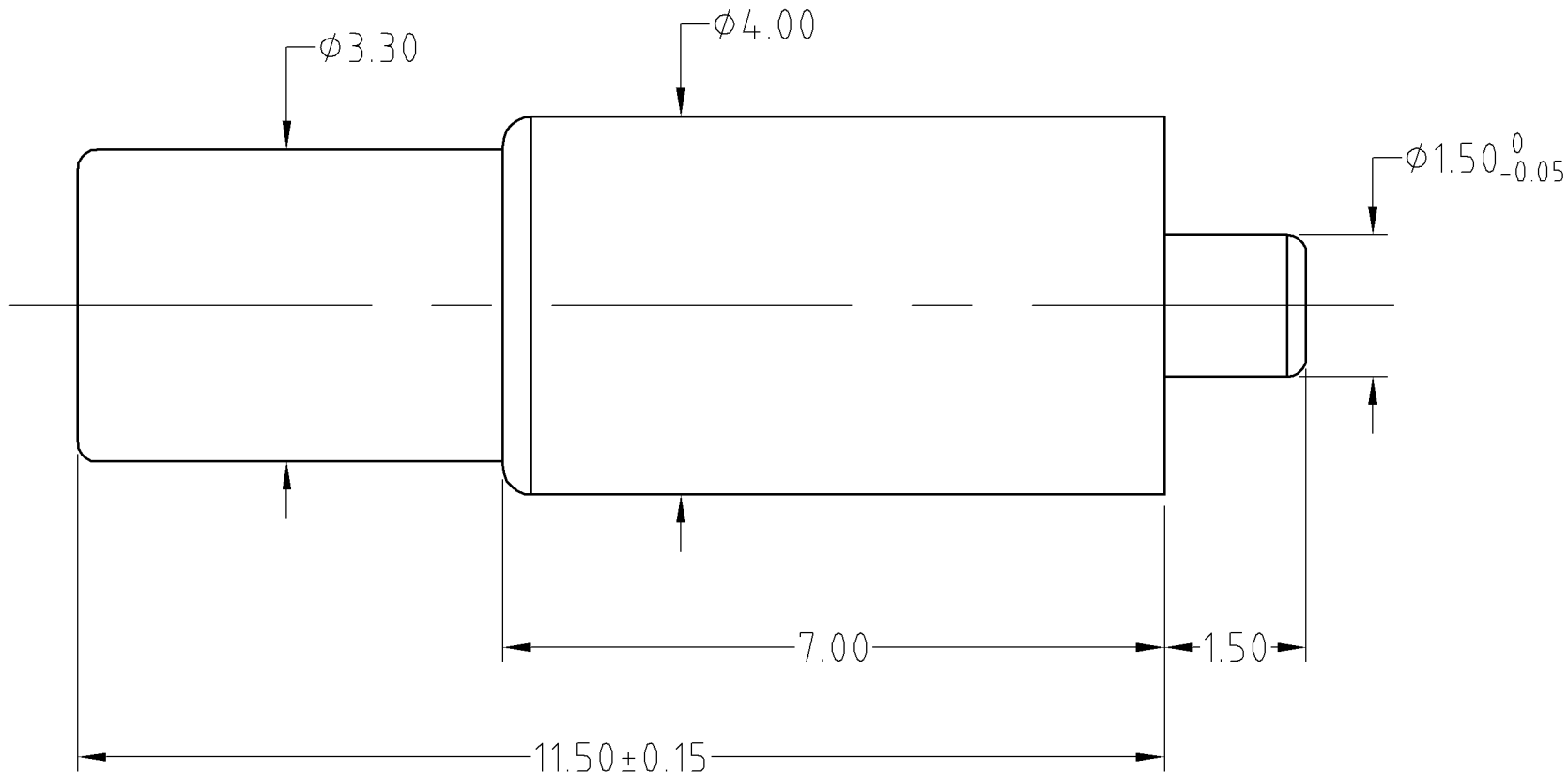

SCALE	10:1	UNIT:mm	THIS DOCUMENT IS THE SOLE PROPERTY OF CFE CORPORATION CO.,LTD., AND SHOULD NOT BE USED IN WHOLE OR IN PART WITHOUT PRIOR WRITTEN PERMISSION.		CFE 东莞市川富电子有限公司 CFE CORPORATION CO.,LTD.
ANGEL	±1°	A4	SHEET: 1 of 1		
0~6	±0.05				PART NO. BP17022
6~30	±0.10	DRAW			FILE NAME BP170XX
30~150	±0.15	CHECK			TITLE. Pogo pin connector
GENERAL TOLERANCE UNLESS OTHERWISE NOTED		APPRO			

	D0	2013.05.30	NEW
ECN(DCN) NO.	REV	DATE	DESCRIPTION