

1

2

3

4

Note:

Materials:

.Plunger: Brass 20u" Au over Ni

.Barrel: Brass 20u" Au over Ni

.Spring: SUS surface treatment

Mechanical:

.Contact force: 110g±20% at 2.0mm working stroke

.Ful stroke: 2.2mm

.Life test: 100,000 cycles

Electrical:

.Rated current & voltage: DC 24V; 1.5A

.Contact resistance: 50 milliohm Max.

To ensure the best usage, please operate it based on the working height.

Based on the engineering drawings, shall not exceed the maximum allowed compression.



Approve Sign

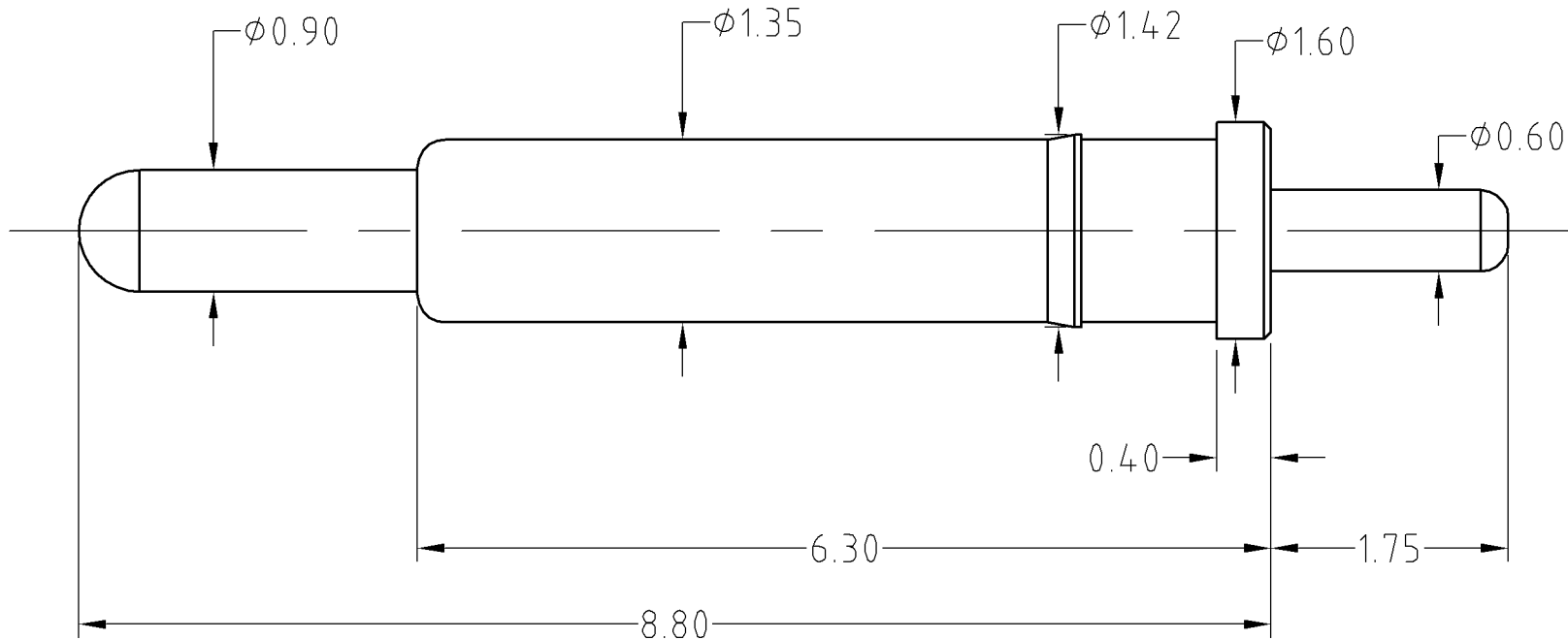

SCALE	10:1	UNIT:mm	THIS DOCUMENT IS THE SOLE PROPERTY OF CFE CORPORATION CO.,LTD., AND SHOULD NOT BE USED IN WHOLE OR IN PART WITHOUT PRIOR WRITTEN PERMISSION.	
ANGEL	$\pm 1^\circ$	A4	SHEET: 1 of 1	
0-6	± 0.05			
6-30	± 0.10	DRAW	PART NO.	BP17701
30-150	± 0.15	CHECK	FILE NAME	BP177XX
GENERAL TOLERANCE UNLESS OTHERWISE NOTED		APPRO	TITLE.	Pogo pin connector



ECN(DCN) NO.	D0	2013.05.30	NEW
REV	DATE	DESCRIPTION	