

1

2

3

4

Note:

Materials:

.Plunger: Brass 0.5um Au over Ni

.Barrel: Brass 0.5um Au over Ni

.Spring: SUS surface treatment

.bead: ceramics

A Mechanical:

.Contact force: 300g±20% at 1.60mm working stroke

.Full stroke:3.2mm

.Life test: 10,000 cycles

Electrical:

.Rated current & voltage: DC 12V; rated current 7.5A , Peak current 12A

.Contact resistance: 20 milliohm Max.

To ensure the best usage, please operate it based on the working height.

Based on the engineering drawings, shall not exceed the maximum allowed compression.



Approve Sign

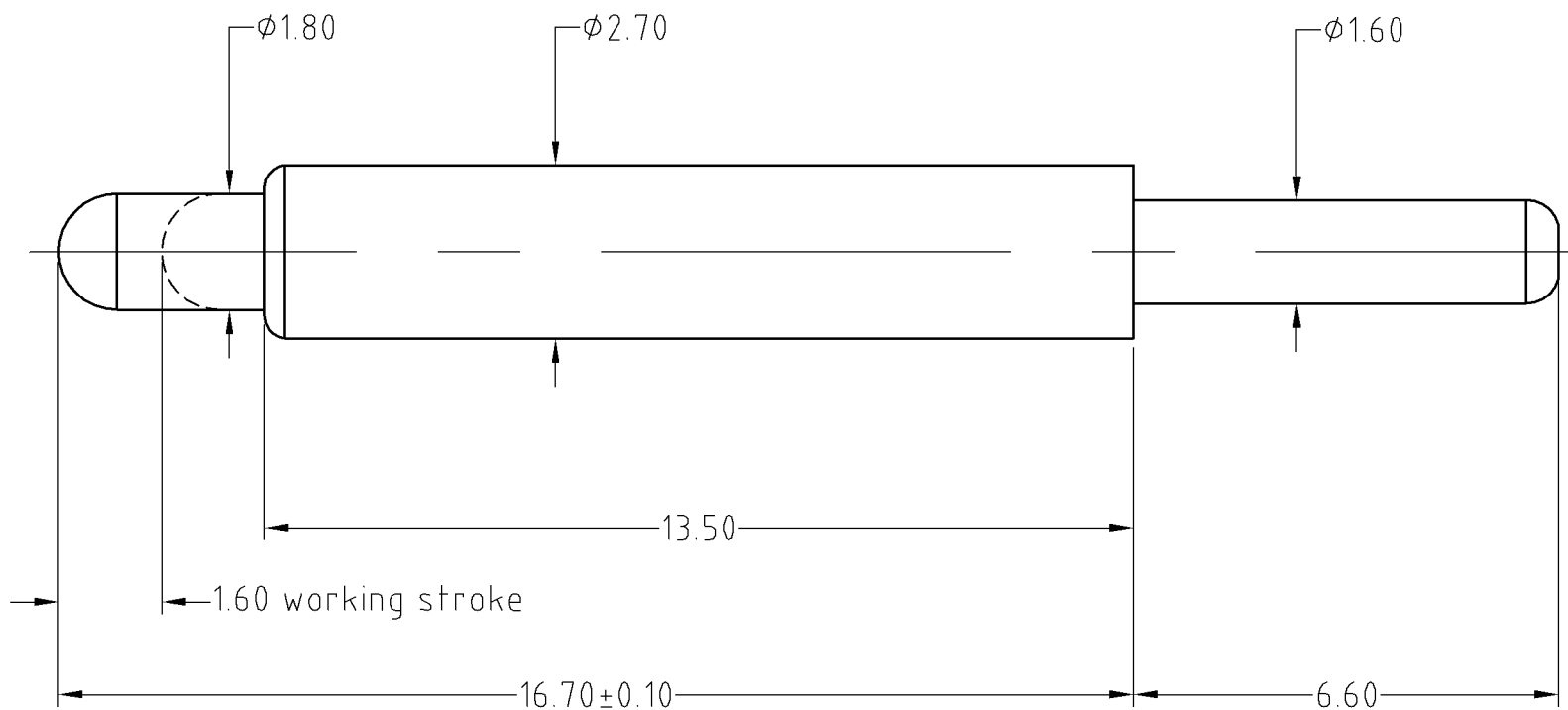

SCALE	10:1	UNIT:mm	THIS DOCUMENT IS THE SOLE PROPERTY OF CFE CORPORATION CO.,LTD., AND SHOULD NOT BE USED IN WHOLE OR IN PART WITHOUT PRIOR WRITTEN PERMISSION.	
ANGEL	$\pm 1^\circ$	A4	SHEET: 1 of 1	
0~6	± 0.05			
6~30	± 0.10	DRAW	PART NO.	BP28611
30~150	± 0.15	CHECK	FILE NAME	BP286XX
GENERAL TOLERANCE UNLESS OTHERWISE NOTED		APPRO	TITLE	Pogo pin connector

东莞市川富电子有限公司
 CFE CORPORATION CO.,LTD.

ECN(DCN) NO.	D0	2014.10.13	NEW
REV	DATE	DESCRIPTION	