

Note:

1. Cannot be used as the charging.

To ensure the best usage, please operate it based on the working height.
Based on the engineering drawings, shall not exceed the maximum allowed compression.



Approve Sign

Working stroke	0.6 mm
Spring force	90g+/-20g
Life test	50,000 cycles
Rated current	1 A
Rated voltage	12 V
Contact resistance	50 milliohm Max.

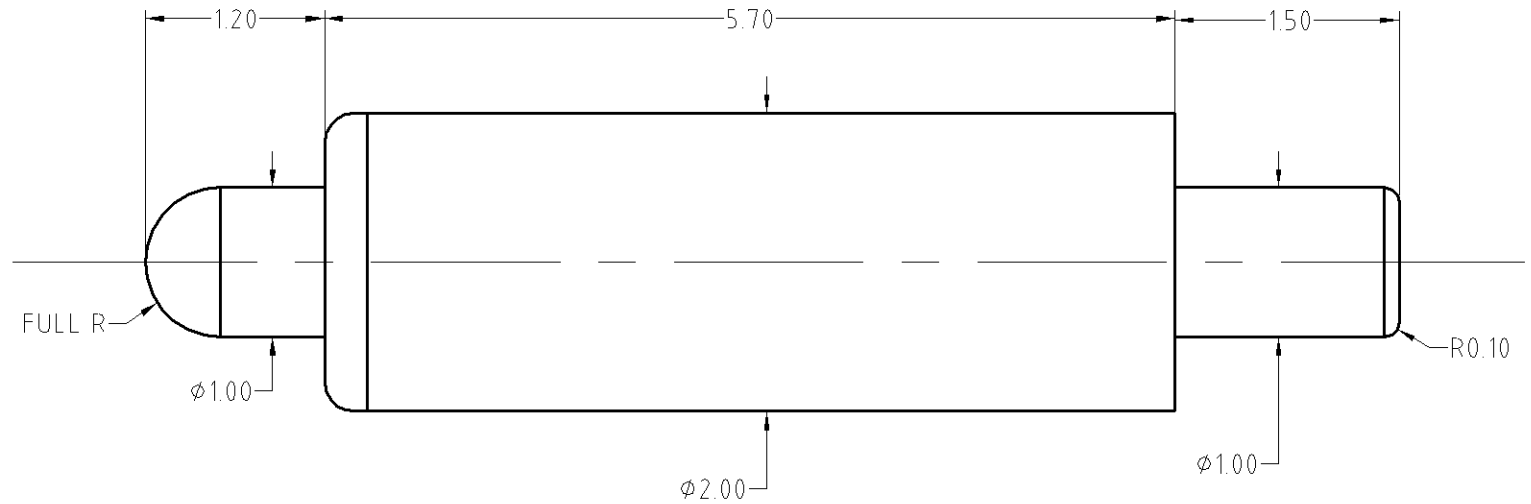

BOM			
No.	Qty	Part	Spec
B435-B1001	1	Barrel	Brass C3604 0.025um Au over Ni
B435-P1001	1	Plunger	Brass C3604 0.025um Au over Ni
B435-S1001	1	Spring	SUS 304 Au 0.025um

SCALE	10:1	UNIT:mm	THIS DOCUMENT IS THE SOLE PROPERTY OF CFE CORPORATION CO.,LTD., AND SHOULD NOT BE USED IN WHOLE OR IN PART WITHOUT PRIOR WRITTEN PERMISSION.	东莞市川富电子有限公司 CFE CORPORATION CO.,LTD.	
ANGEL	$\pm 1^\circ$	A4			
0-6	± 0.05		SHEET: 1 of 1	PART NO.	BP43511
6-30	± 0.10	DRAW		FILE NAME	BP435XX
30-150	± 0.15	CHECK		TITLE	Pogo pin connector
GENERAL TOLERANCE UNLESS OTHERWISE NOTED		APPRO			

ECN(DCN) NO.	REV	DATE	DESCRIPTION
	D0	2015.05.18	NEW