

No.	Qty	Part	Spec
B439-B1001	1	Barrel	Brass C3604 0.025um Au over Ni
B439-P1001	1	Plunger	Brass C3604 0.025um Au over Ni
B439-S1001	1	Spring	SUS 304 Au 0.025um

To ensure the best usage, please operate it based on the working height.  
Based on the engineering drawings, shall not exceed the maximum allowed compression.

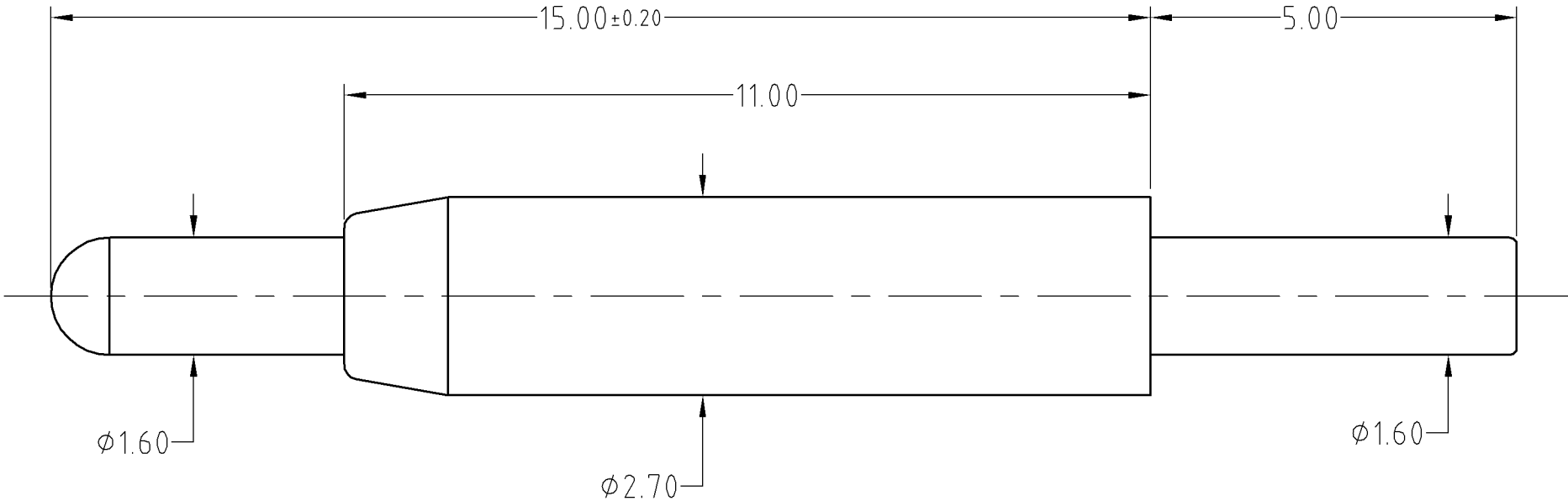

Approve Sign  
\_\_\_\_\_



Note:

Working stroke	4.0 mm
Spring force	800g±20%
Life test	10,000 cycles
Rated current	3 A
Rated voltage	24 V
Contact resistance	30 milliohm Max.

SCALE	10:1	UNIT:mm	THIS DOCUMENT IS THE SOLE PROPERTY OF CFE CORPORATION CO.,LTD., AND SHOULD NOT BE USED IN WHOLE OR IN PART WITHOUT PRIOR WRITTEN PERMISSION.	SHEET: 1 of 1	PART NO.	BP43911
ANGEL	±1°	A4				
0-6	±0.05				TITLE	Pogo pin connector
6-30	±0.10	DRAW				
30-150	±0.15	CHECK				
GENERAL TOLERANCE UNLESS OTHERWISE NOTED		APPRO				



ECN(DCN) NO.	REV	DATE	DESCRIPTION
	D0	2013.05.30	NEW