

Note:

Materials:

.Plunger: Beryllium Copper C17300 0.075um Au over 1.25um-2.5um Ni

.Barrel: Brass 0.075um Au over 1.25um-2.5um Ni

.Spring: SUS 304 surface treatment

Mechanical:

.Contact force: 70g±15% at 3.10mm working storke.

.Max. storke: 3.90mm

.Life test: 20,000 cycles

Electrical:

.Rated current & voltage: DC 12V; 1A

.Contact resistance: 50 milliohm Max.

.Critical Dimension: *

To ensure the best usage, please operate it based on the working height.
Based on the engineering drawings, shall not exceed the maximum allowed compression.



Approve Sign

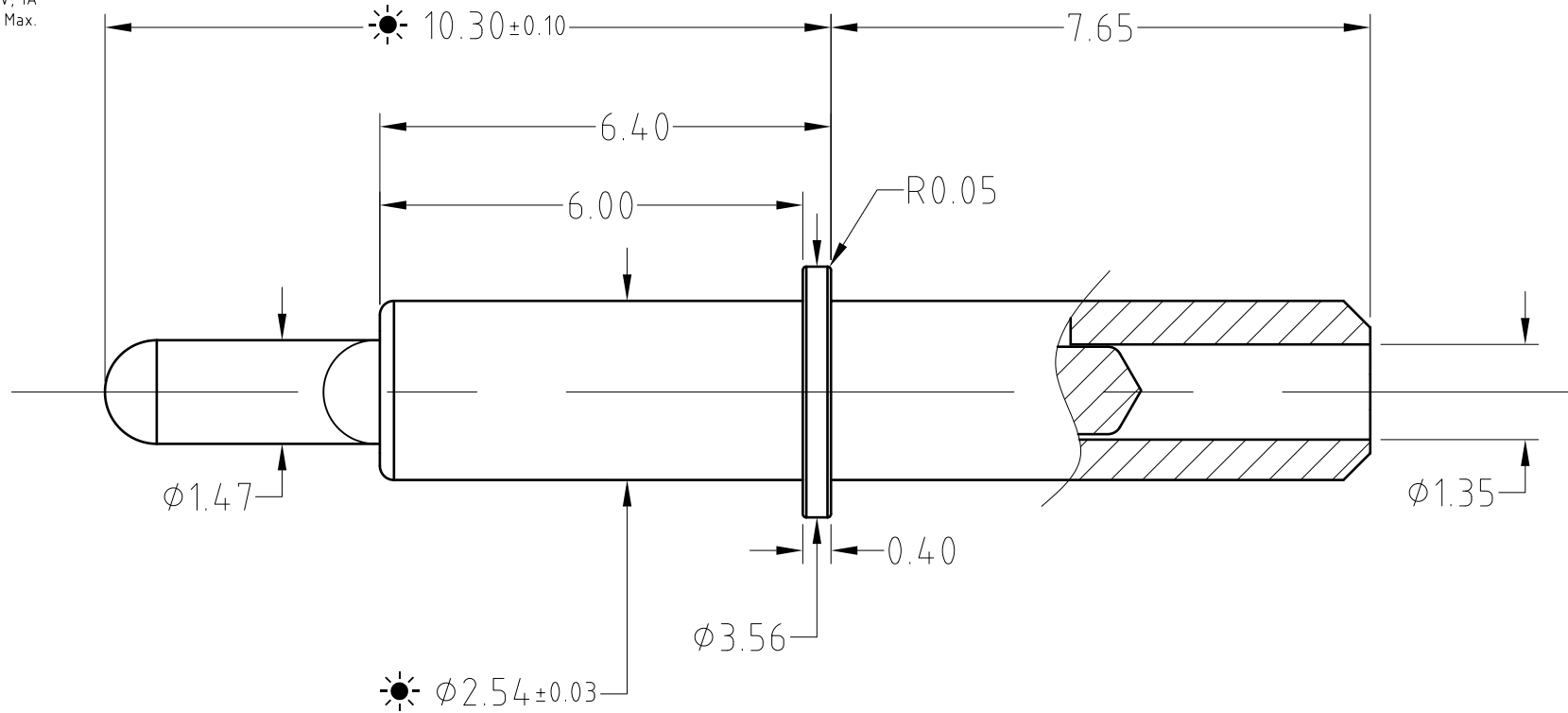

BOM		
Part	NO.	Qty
Plunger	B501-P1003	1
Barrel	B501-B1003	1
Spring	B501-S1001	1

SCALE	10:1	UNIT:mm	THIS DOCUMENT IS THE SOLE PROPERTY OF CFE CORPORATION CO.,LTD., AND SHOULD NOT BE USED IN WHOLE OR IN PART WITHOUT PRIOR WRITTEN PERMISSION.	SHEET: 1 of 1	PART NO.	BP50111
ANGEL	±1°	A4				
	0~6	±0.10			FILE NAME	BP501XX
	6~30	±0.20			TITLE	Pogo pin
	30~150	±0.30				
GENERAL TOLERANCE UNLESS OTHERWISE NOTED			APPRO			



ECN(DCN) NO.	REV	DATE	DESCRIPTION
	A0	2015.09.23	NEW