

1

2

3

4

Note:

Materials: .Plunger: Brass 0.125um Au over Ni .Barrel: Brass 0.125um Au over Ni .Spring: SUS 304 Au

Mechanical: .Contact force: 100g±20% at 1.0mm working stroke .Max. stroke: 1.5mm .Life test: 50,000 cycles

Electrical: .Rated current & voltage: DC 12V; 1A .Contact resistance: 50 milliohm Max.

To ensure the best usage, please operate it based on the working height. Based on the engineering drawings, shall not exceed the maximum allowed compression.



Approve Sign

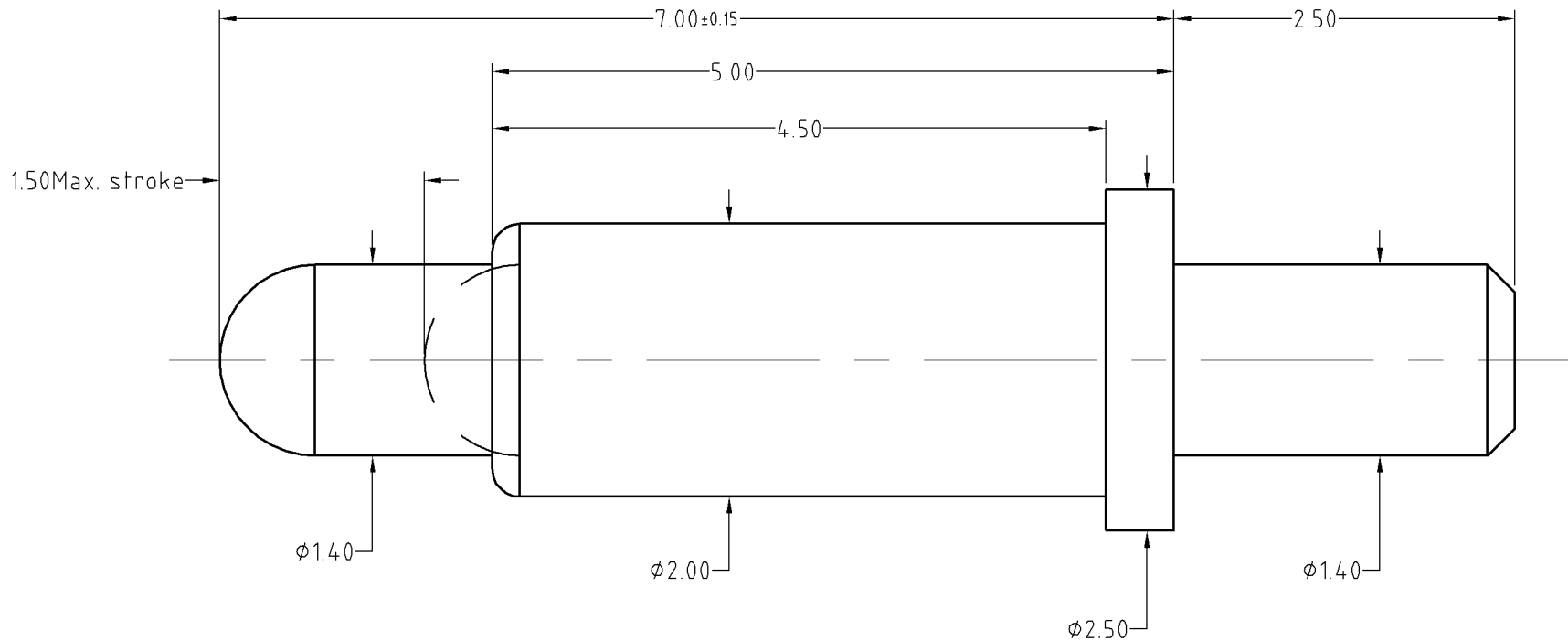

BOM		
Part	NO.	Qty
Plunger	B572-P1005	1
Barrel	B572-B1005	1
Spring	B572-S1001	1

SCALE	10:1	UNIT:mm	THIS DOCUMENT IS THE SOLE PROPERTY OF CFE CORPORATION CO.,LTD., AND SHOULD NOT BE USED IN WHOLE OR IN PART WITHOUT PRIOR WRITTEN PERMISSION.	SHEET: 1 of 1		
ANGEL	±2°	A4				
0~6	±0.05			PART NO.	BP57211	
6~30	±0.10	DRAW		FILE NAME	BP572XX	
30~150	±0.15	CHECK	GENERAL TOLERANCE UNLESS OTHERWISE NOTED	APPRO	TITLE.	Pogo pin

CFE 东莞市川富电子有限公司 CFE CORPORATION CO.,LTD.

ECN(DCN) NO.	D0	2013.05.30	NEW
REV	DATE	DESCRIPTION	