

1

2

3

4

Note:

Materials:

.Plunger: Brass 0.25um Au over Ni

.Barrel: Brass 0.25um Au over Ni

.Spring: SUS Au

Mechanical:

.Contact force: 60g±15g at 8.30mm working height

.Life test: 20,000 cycles

Electrical:

.Rated current & voltage: DC 12V; 1A Max.

.Contact resistance: 50 milliohm Max.

To ensure the best usage, please operate it based on the working height.

Based on the engineering drawings, shall not exceed the maximum allowed compression.



Approve Sign

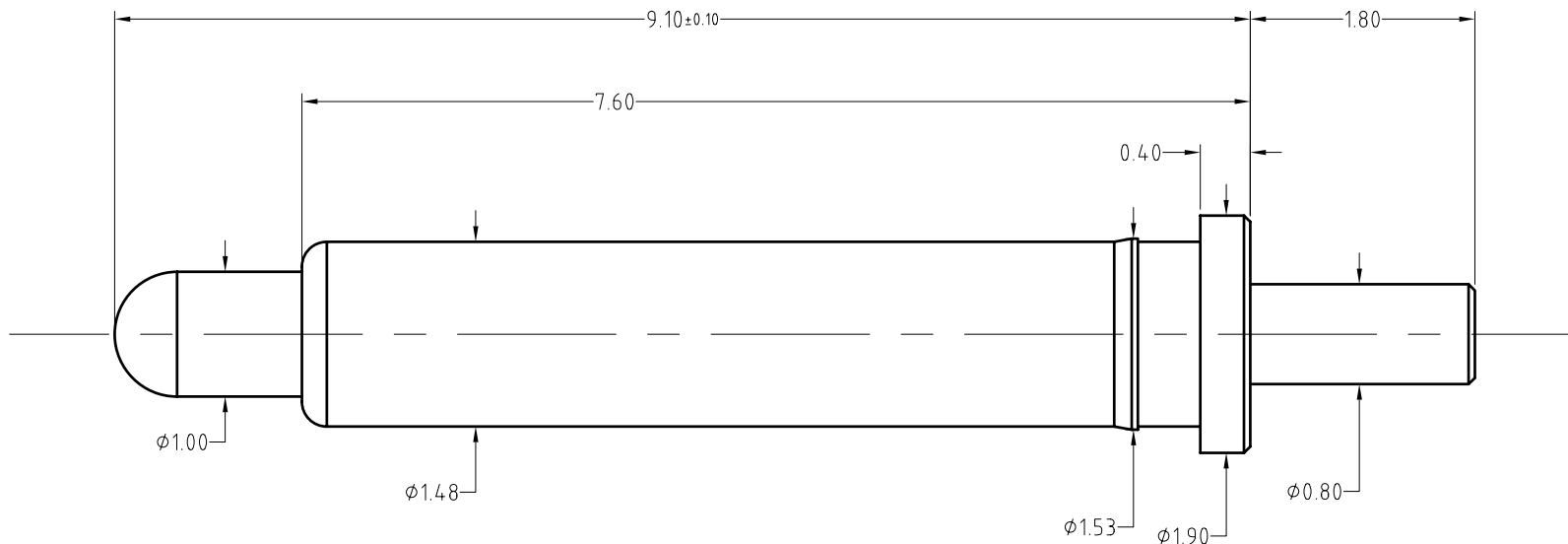

BOM

Part	NO.	Qty
Plunger	B388-P1010	1
Barrel	B479-B1010	1
Spring	B479-S1001	1

SCALE	10:1	UNIT:mm	THIS DOCUMENT IS THE SOLE PROPERTY OF CFE CORPORATION CO.,LTD., AND SHOULD NOT BE USED IN WHOLE OR IN PART WITHOUT PRIOR WRITTEN PERMISSION.	SHEET: 1 of 1	PART NO.	BP47911
ANGEL	±1°	A4				
0~6	±0.10				FILE NAME	BF479XX
6~30	±0.20	DRAW			TITLE.	Pogo pin connector
30~150	±0.30	CHECK				
GENERAL TOLERANCE UNLESS OTHERWISE NOTED		APPRO				

CFE 东莞市川富电子有限公司
 CFE CORPORATION CO.,LTD.

ECN(DCN) NO.	REV	DATE	DESCRIPTION
	A0	2015.11.12	NEW