

1

2

3

4

Note:  
 Materials:  
 .Plunger: Brass 0.5um Au over Ni  
 .Barrel: Brass 0.25um Au over Ni  
 .Spring: SUS 304 Au  
 Mechanical:  
 .Contact force: 120g±20% at 4.0mm working stroke  
 .Max. stroke: 5.30mm  
 .Life test: 100,000 cycles  
 Electrical:  
 .Rated current & voltage: DC 12V; 3A  
 .Contact resistance: 50 milliohm Max.

To ensure the best usage, please operate it based on the working height.  
 Based on the engineering drawings, shall not exceed the maximum allowed compression.



Approve Sign

--

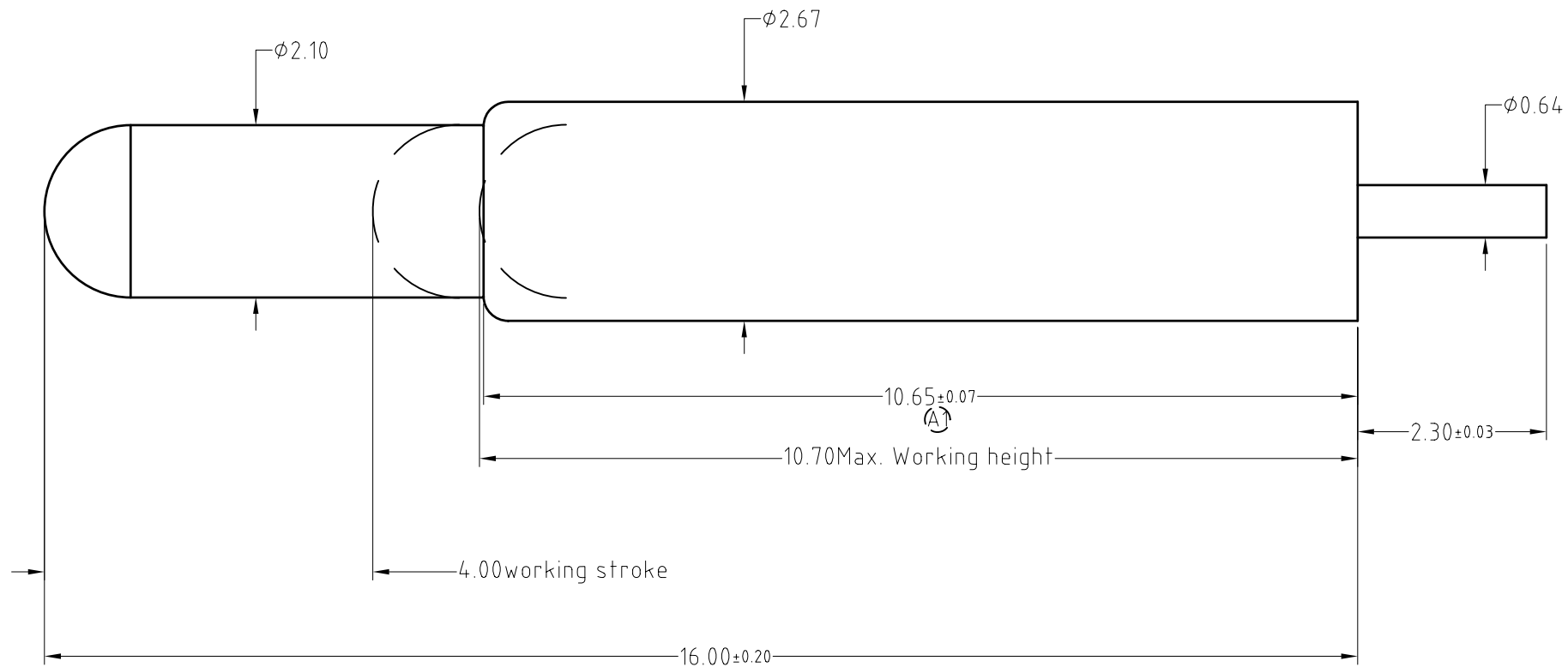

BOM		
Part	NO.	Qty
Plunger	B601-P1020	1
Barrel	B601-B1010	1
Spring	B601-S1001	1

SCALE	10:1	UNIT:mm	THIS DOCUMENT IS THE SOLE PROPERTY OF CFE CORPORATION CO.,LTD., AND SHOULD NOT BE USED IN WHOLE OR IN PART WITHOUT PRIOR WRITTEN PERMISSION.
ANGEL	±2°	A4	
0~6	±0.05		
6~30	±0.10	DRAW	
30~150	±0.15	CHECK	SHEET: 1 of 1
GENERAL TOLERANCE UNLESS OTHERWISE NOTED		APPRO	



	A1	2016.04.23	修改针管长度
	A0	2016.02.23	NEW
ECN(DCN) NO.	REV	DATE	DESCRIPTION

PART NO.	BP60111
FILE NAME	BP601XX
TITLE.	Pogo pin