

1

2

3

4

Note:

Materials:

- .Insulator: Black high temperature plastics U194 V-0
- .Plunger: Brass 0.5um Au over Ni
- .Barrel: Brass 0.5um Au over Ni
- .Spring: SUS surface treatment

To ensure the best usage, please operate it based on the working height.
Based on the engineering drawings, shall not exceed the maximum allowed compression.

Mechanical:

- .Contact force: 110g±20% at 2.0mm working stroke
- .Ful stroke: 2.2mm
- .Life test: 100,000 cycles

Electrical:

- .Rated current & voltage: DC 24V; 1.5A
- .Contact resistance: 50 milliohm Max.

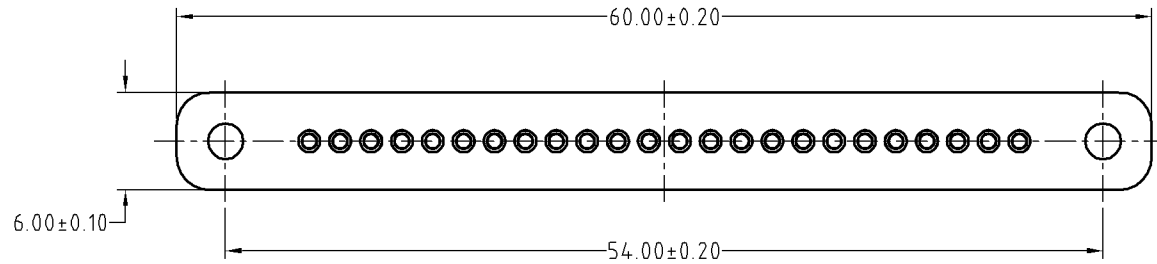

Approve Sign

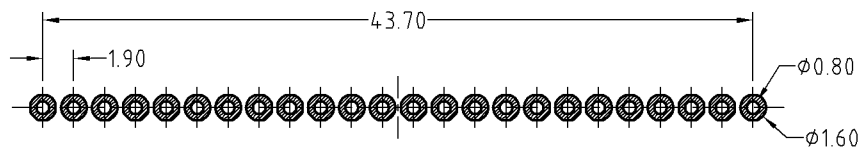
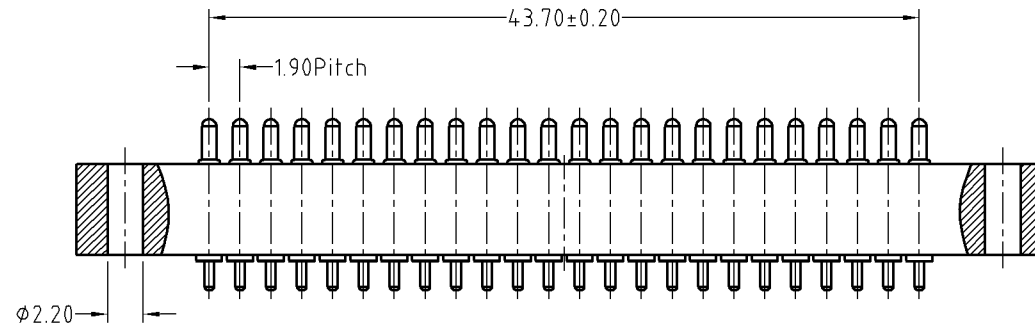
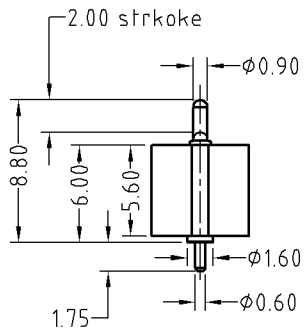

Recommended pcb layout
layout tolerance: ±0.05mm

SCALE	10:1	UNIT:mm	THIS DOCUMENT IS THE SOLE PROPERTY OF CFE CORPORATION CO.,LTD., AND SHOULD NOT BE USED IN WHOLE OR IN PART WITHOUT PRIOR WRITTEN PERMISSION.	SHEET: 1 of 1	
ANGEL	±1°	A4			
0-6	±0.05			PART NO.	BP17701-24190H0A
6-30	±0.10	DRAW		FILE NAME	BP177XX
30-150	±0.15	CHECK	GENERAL TOLERANCE UNLESS OTHERWISE NOTED	TITLE.	Pogo pin connector
		APPRO			

CFE 东莞市川富电子有限公司
CFE CORPORATION CO.,LTD.

_____	A0	2015.01.21	NEW
ECN(DCN) NO.	REV	DATE	DESCRIPTION